

# PWCA-100S

Waveguide to Coaxial Adapter,  
WR90 to SMA Female,FBP100 Square



## Electrical

<b>Frequency Range</b>	8.2-12.5 GHz	<b>Waveguide Size</b>	WR90/R100
<b>Impedance</b>	50 ohm	<b>Flange Type</b>	UBR100/FBP100,Square
<b>VSWR</b>	1.2 Max	<b>Coax Connector</b>	SMA Female
<b>Average Power</b>	-	<b>Body Geometry</b>	Right Angle

## Configuration

## Materials

<b>Waveguide Body</b>	Aluminum, black or grey painted	<b>Operating Temp</b>	-40°C to 70°C
<b>Connector Body</b>	Passivated stainless steel	<b>Connector Interface</b>	MIL-STD-348
<b>Center Contact</b>	Gold plated beryllium copper	<b>RoHS</b>	Compliant

## Mechanical & Environmental

## Dimensions(mm) Tolerance±1%

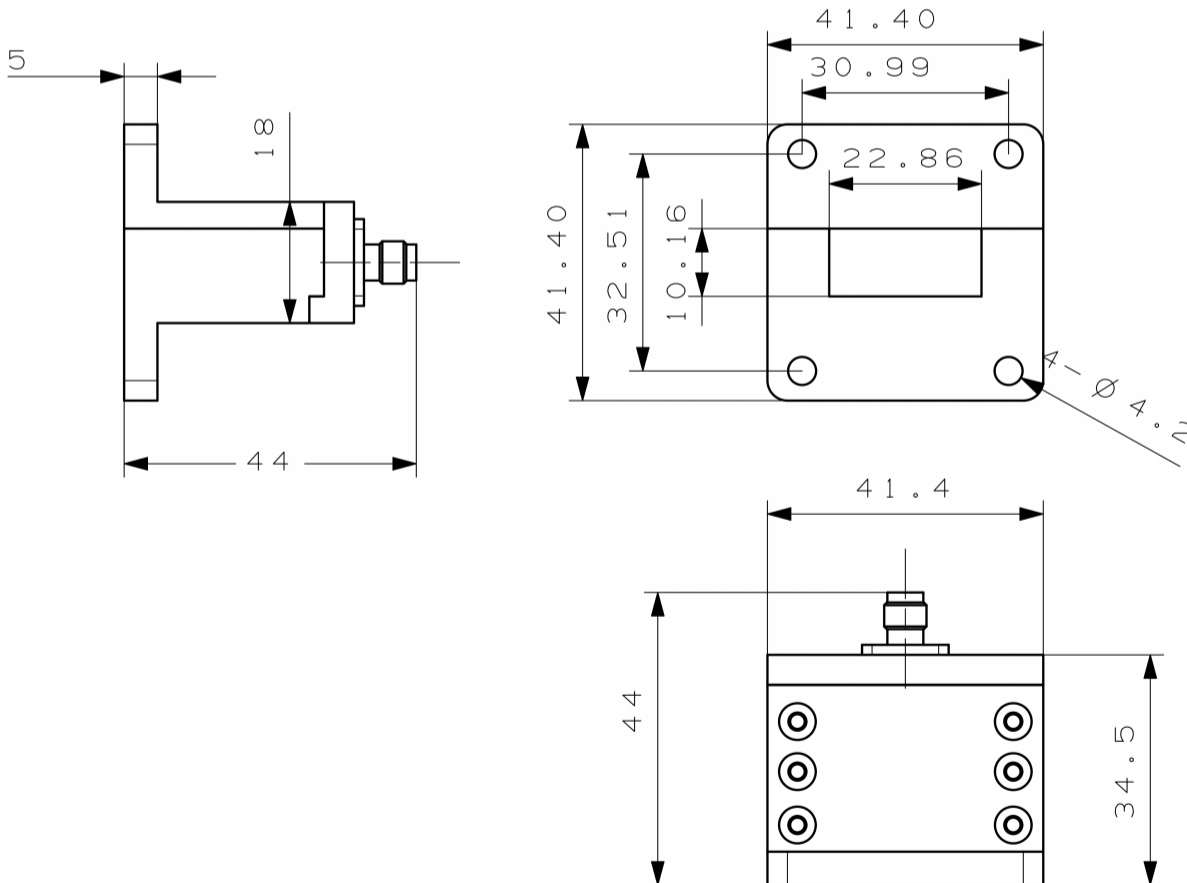

## Typical Test Data

